

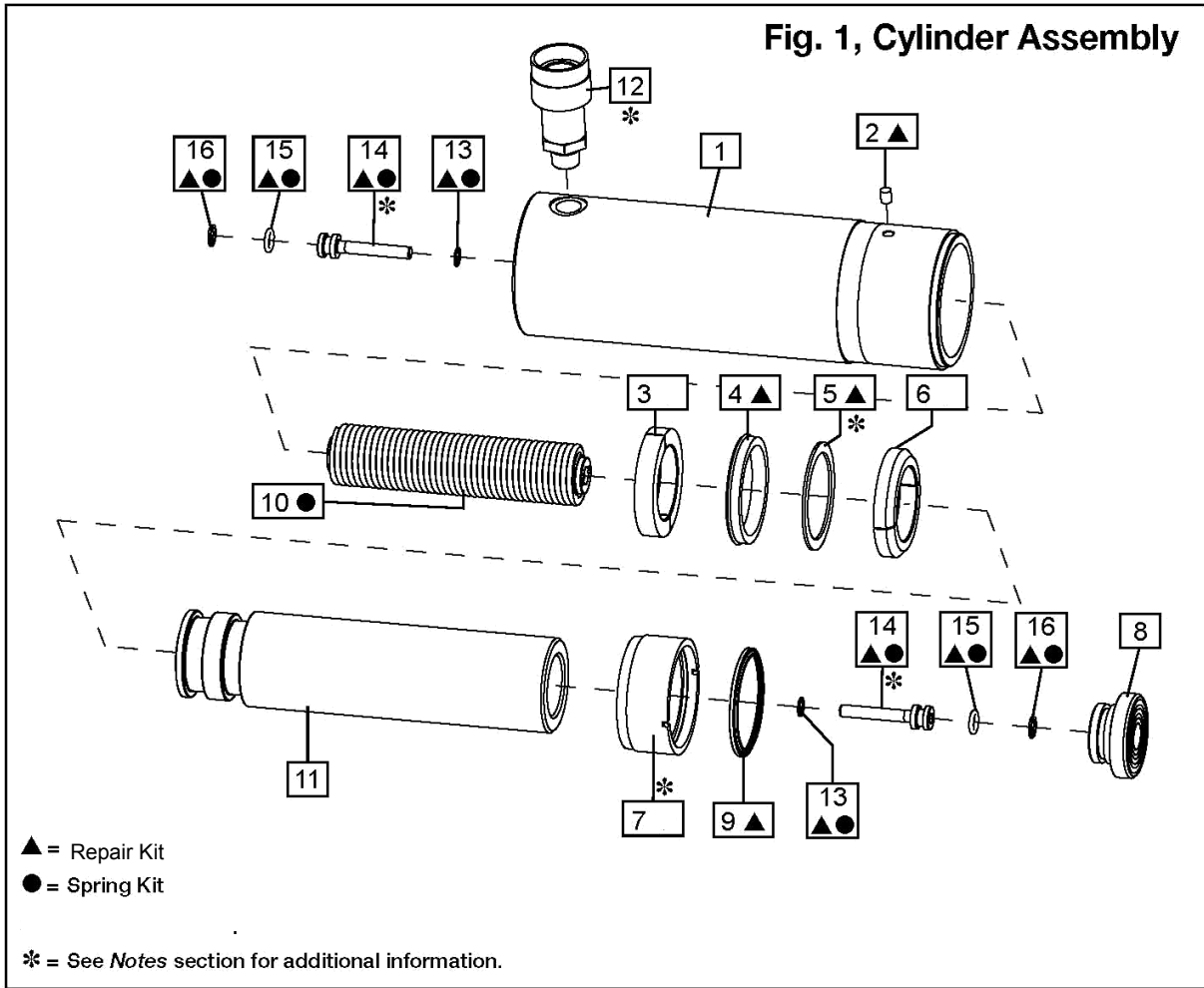

INSTRUCTION MANUAL

Parts List For Cylinder, 25 Ton, 6" Stroke Model 13100



**Note: See Page 2
for parts list.**

| (*) Notes | |
|-----------|--|
| Item | Torque / notes |
| 5 | Washer to be placed with the sharp edge towards U-Cup. |
| 7 | 7.9 - 10.2 Nm, 70 - 90 In - Lbs |
| 7 | Secure with Loctite 222. |
| 12 | 54 - 81 Nm, 40 - 60 Ft - Lbs |
| 12 | Use Loctite 545 or Teflon tape. |
| 14 | 10.2 - 12.4 Nm, 90 - 110 In - Lbs |



INSTRUCTION MANUAL

Parts List For Cylinder, 25 Ton, 6" Stroke Model 13100

| Item | Part Number | Description | Qty. |
|---|----------------|-----------------|------|
| 1 | 13100-001 | Cylinder Body | 1 |
| 2 | 13100-002 (▲) | Filter | 1 |
| 3 | 13100-003 | Bearing, Bottom | 1 |
| 4 | 13100-004 (▲) | U-Cup | 1 |
| 5 | 13100-017 (▲) | Washer | 1 |
| 6 | 13100-006 | Bearing, Top | 1 |
| 7 | 13100-007 | Stop Ring | 1 |
| 8 | 13100-008 | Saddle, Grooved | 1 |
| 9 | 13100-009 (▲) | Wiper Ring | 1 |
| 10 | 13100-010 (●) | Spring | 1 |
| 11 | 13100-011 | Piston | 1 |
| 12 | 16060 | Coupler | 1 |
| 13 | 13100-013 (▲●) | Gasket | 2 |
| 14 | 13100-014 (▲●) | Spring Retainer | 2 |
| 15 | 13100-015 (▲●) | O-Ring | 2 |
| 16 | 13100-016 (▲●) | Back-Up | 2 |
| ▲ | 13100 RK | Repair Kit | - |
| ● | 13100 SK | Spring Kit | - |
| Notes: Repair Kit includes all repair kit items (▲). Spring Kit includes all (●) | | | |